

**ACCOSON**



MANUFACTURED  
IN THE UK



**VIEW WEBSITE**

# PRODUCT BROCHURE

Manufacturing high quality diagnostic devices for  
clinical professionals since 1859.



## ACCOSON™ history

The Company was established as A. C. COSSOR & Son in 1859 by *Alfred Charles Cossor* as a glass blower.

In 1904, ACCOSON produced their first glass manometer, using their glass blowing skills, known as the sphygmomanometer.

A year later, Russian surgeon *Nikolai Korotkoff* first described the technique to measure diastolic pressure.

The business has since passed over four generations, before more recently joining the HCE Medical Group.



1923 A.C. Cossor Advert

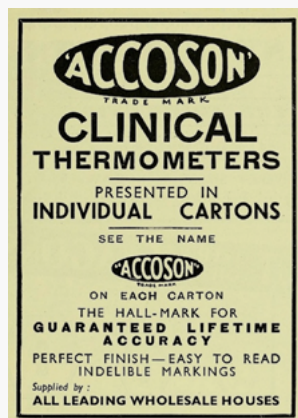

1935 'ACCOSON' Advert

## Greenlight 300 awards

We are proud to have won two awards for the creation of this device:

**dti**

1. A Department of Trade and Industry, UK award for the successful transfer of innovative technology. This was following the collaboration between AC Cossor & Son, the Regional Medical Physics Department of Freeman Hospital and the University of Newcastle in the UK



2. A UK National Health Service (NHS) Innovations North Special Exploitation Award for the innovation and successful development of a device designed for use in the NHS

# greenlight 300

## Desk Model fitted with Stand Conversion Kit

- A large container for the cuff and tubing on which the greenlight 300 is fitted
- Gauge set at an angle for easy viewing
- A mounting stem with adjustable height, with five castors for mobility and stability



## AWARD WINNING PRODUCT

The greenlight 300 has been developed to provide a reliable and accurate alternative to mercury devices. This is achieved using silicon chip technology replacing the traditional mercury column with an electronic pressure detection system.

Overcoming problems associated with other types of sphygmomanometer: The greenlight 300 is non-toxic, robust and importantly, automatically self-calibrates to zero when switched on, thus ensuring reliable accuracy.

The traditional mercury display is replaced with LEDs clearly displaying pressure in steps of 2 mmHg, and the clinically important cuff pressure deflation rate is indicated.

Shown to be compliant with the US standard for non-automated sphygmomanometers, ANSI/AAMI SP9:1994, and has been approved by the FDA (K040410). It has also been shown to be compliant with the European standards BS EN ISO 81060-1 and BS EN 1060-3.

Validated to the ESH International Protocol by the Mayo Clinic, the greenlight 300 is also sold as a test reference manometer for calibrating and checking aneroid devices – chosen by leading pharmaceutical companies for their testing services in the UK.

- 10 Year calibration warranty as standard
- Proven to be more accurate than mercury<sup>1</sup>
- Accuracy of +/- 3mmHg
- Very long battery life of up to 170 hours
- Frequent calibration checks not required
- Displayed cuff deflation rate
- Latex free inflation system & coiled tubing
- Approved by the British Hypertension Society
- Desk model supplied as standard

1. Graves JW et al. The Accoson Greenlight 300, the first non-automated mercury free blood pressure device to pass the International Protocol for blood pressure measuring devices in adults. *Blood Pressure Monitoring* 2003;9:13-7

Code	Product Description
0702A	Greenlight with Adult Ambidex Cuff
0709A	Greenlight with Lrg Adult Ambidex Cuff
1772	Wall Conversion Kit
1774	Stand Conversion Kit
1775	Protective Carry Case with Zipper



## Six<sup>00</sup> Series of Aneroid Sphygmomanometers

Our premium range of high quality aneroid sphygmomanometers.

This robust product range is designed to last with an enhanced protective enclosure.

- Made in UK and guaranteed accuracy to ISO 81060-1
- Lightweight ABS cuff container which is very easy to clean
- New flexible shock mount resists any damage to the gauge
- Fine red pointer ensures consistently precise indication
- Tough bright white ABS construction with built in carrying handle
- Accuracy of +/- 3mmHg
- Range 0–300mmHg, with scale graduations from zero
- Supplied with a 3 year calibration warranty



Code	Product Description
0632A	Desk Six <sup>00</sup> with Adult Ambidex Cuff
0642A	Wall Six <sup>00</sup> with Adult Ambidex Cuff
0662A	Stand Six <sup>00</sup> with Adult Ambidex Cuff

## 6 Inch Series of Aneroid Sphygmomanometers

Offering great quality at an affordable price.

A modern solution for all locations with useful, practical features for users.

- Made in UK and guaranteed accuracy to ISO 81060-1
- Lightweight ABS cuff container which is very easy to clean
- New flexible shock mount resists any damage to the gauge
- Fine red pointer ensures consistently precise indication
- Accuracy of +/- 3mmHg
- Range 0–300mmHg, with scale graduations from zero
- Tough bright white ABS construction with built in underlip handle
- Supplied with a 1 year calibration warranty



Code	Product Description
0332A	6 Inch Desk with Adult Ambidex Cuff
0342A	6 Inch Wall with Adult Ambidex Cuff
0362A	6 Inch Stand with Adult Ambidex Cuff





Code	Product Description
0292A	Limpet with Adult Ambidex Cuff



Code	Product Description
0312A	Pocket with Adult Ambidex Cuff



Code	Product Description
0322A	Duplex with Adult Ambidex Cuff
0322AB	Blue Duplex with Adult Ambidex Cuff
0322AB	Red Duplex with Adult Ambidex Cuff

## Portable Aneroid Sphygmomanometers

Our portable series is a range of aneroid sphygmomanometers offering smaller, more lightweight devices which are the perfect transportable option for clinicians looking to aid patients across a variety of settings.

This range of sphygmomanometers allow you to meet the requirements of each of your patients in almost any environment and situation. These are the perfect solution when on-the-go.

These portable aneroid (mechanical) devices don't use mercury but provide accurate results when calibrated correctly.

Each sphygmomanometer from this range is supplied complete with an ACCOSON™ ambidex cuff as well as a soft zipper case, helping to protect the device when in transit.

- Made in UK and guaranteed accuracy to ISO 81060-1
- Three variations available to ensure your requirements are met
- Accuracy of +/- 3mmHg
- Range 0–300mmHg, with the scale graduations starting at zero
- Clear white face with fine pointer which allows for precise indication
- One handed use, suitable for both left and right hands
- Aneroid (mechanical), devices don't use mercury but provide accurate results when calibrated.
- Smaller, lighter and easily portable
- Fitted with Ambidex anti-microbial cuff, with our own unique soft edges
- The ideal option for use on-the-go
- Capable of withstanding 100% overpressure
- Supplied complete with a soft, black protective zipper case
- Duplex model available in standard black or as blue/red to allow for easy identification of department/user

### Pressure Infusion Cuff

Our latex free infusion cuff is made to aid rapid IV infusion with an integrated gauge and handbulb.

- Made in United Kingdom
- Large scale accurate pressure gauge
- Gauge protector
- Strong fine mesh front
- Infusion cuff includes inflation bulb with a release valve
- Completely latex free
- Components available as spare parts



Code	Product Description
0210	1 Litre Pressure Infusion Cuff
0205	0.5 Litre Pressure Infusion Cuff

### Combine Self Test

Accurate aneroid sphyg combined with integrated stethoscope for self testing.

- Made in United Kingdom
- Guaranteed accurate to ISO 81060-1
- One-handed use, suitable for right/left
- Accuracy of +/- 3mmHg
- Range 0-300mmHg
- Supplied with adult velcro cuff, bulb & case



Code	Product Description
400	Combine Self Test

### Single Patient Cuffs

Disposable blood pressure cuffs, for single patient use.

Support infection control in your clinic by utilising these single patient use cuffs.

Specifically designed for use with the ACCOSON™ sphygmomanometer range.

- Completely Latex Free
- Specifically designed as single patient use
- Cuffs are available in either single or double tube
- Suitable for use with all ACCOSON™ sphygmomanometers
- Supplied in a pack of 5 cuffs



Code	Product Description
1291SPU	Single Tube Infant (13.5–19.5cm)
1281SPU	Double Tube Infant (13.5–19.5cm)
1294SPU	Single Tube Child (18–27.2cm)
1284SPU	Double Tube Child (18–27.2cm)
1290SPU	Single Tube Adult (26–35cm)
1280SPU	Double Tube Adult (26–35cm)
1293SPU	Single Tube Lrg Adult (34.3–51cm)
1283SPU	Double Tube Lrg Adult (34.3–51cm)
1298SPU	Single Tube Thigh (40.6–66.5cm)
1288SPU	Double Tube Thigh (40.6–66.5cm)

## Ambidex Innovative blood pressure cuffs

### One-piece cuffs developed to be easy to use, clean, multi-purpose and cost-effective

Features a unique soft edge which replaces the weld found on other cuffs, ensuring equal comfort for the patient.

These bladderless blood pressure cuffs can be used as a regular cuff, or for single patient use. Each carries a white panel on which a patient's name or the cuff location details can be recorded.

- Unique Ambidex comfort edge
- Ambidextrous cuff design can be used on either left or right arm
- Inlet tube positioned in the centre of the cuff face frees space for the stethoscope and keeps tubing on the outside of the arm
- Cuff Range and artery position indicator can be read when cuff is on either arm
- Full range of sizes based on British Hypertension Society's recommendations
- Completely latex free
- Panel for single patient or cuff identification notes if required
- Tab for aneroid gauge, which can also be used as a tube tidy
- Easily cleaned and antimicrobial treated

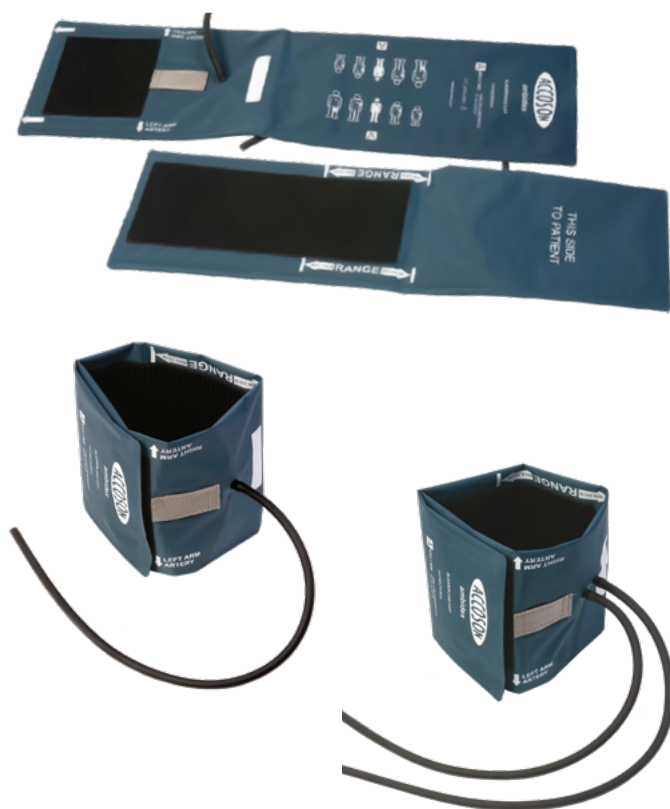

Code	Product Description
1296	Single Tube Infant (13–19cm)
1286	Double Tube Infant (13–19cm)
1294	Single Tube Child (18–25cm)
1284	Double Tube Child (18–25cm)
1290	Single Tube Adult (24–35cm)
1280	Double Tube Adult (24–35cm)
1293	Single Tube Lrg Adult (34–46cm)
1283	Double Tube Lrg Adult (34–46cm)
1298	Single Tube Thigh (45–60cm)
1288	Double Tube Thigh (45–60cm)

### Cuff Sizing

Inappropriate cuff size can result in incorrect readings. Using a small cuff may result in erroneously high blood pressure readings, while a larger cuff may give out erroneously low blood pressure readings.

The inflatable part of the cuff should cover at least 80% of the circumference of the patient's upper arm. ACCOSON™ have a full range of cuff size variants available to order, we are also able to manufacture specialised cuff sizes on request.





## Cardiology Stethoscope

The Cardiology Stethoscope offers medical professionals one of the highest quality stethoscopes available on the market.

Manufactured from the finest stainless steel, with dual tunable diaphragm

- Made in UK
- Adult and convertible paediatric chestpiece for optimum acoustic sensitivity
- Dual tunable diaphragm for monitoring high and low frequencies
- Extra adult bell for low frequency response
- The chestpiece is precisely machined to exacting tolerance from surgical stainless steel for outstanding performance
- Available in your preferred choice of three tubing colours
- Space alloy binaural assembly with dual lumen tubing
- Non-chill ring provides patient comfort
- Silicon soft-sealing eartips
- Overall length 700 mm.



Code	Product Description
CST-BL	Black Tube Stethoscope
CST-HG	Green Tube Stethoscope
CST-BR	Burgundy Tube Stethoscope

## Physician Stethoscope

Offering rugged durability combined with high acoustic response.

Our Physician stethoscope is the perfect choice for both hospital doctors and GPs.

- Made in UK
- Superior acoustic response and rugged durability
- The chestpiece is precisely machined to exacting tolerance from surgical stainless steel for outstanding performance
- Available in your preferred choice of three tubing colours
- This stethoscope is supplied in a foam lined box with two extra sets of soft sealing eartips and one diaphragm
- Overall length 770 mm



Code	Product Description
PST-BL	Black Tube Stethoscope
PST-NB	Blue Tube Stethoscope
PST-BR	Burgundy Tube Stethoscope



## Nursing Stethoscope

**Lightweight, economical stethoscope ideally used by nurses.**

This budget-friendly option offers an effective and elegant solution for all your day-to-day nursing needs.

- Made in UK
- Extra fine acoustic response and light design for extraordinary comfort
- The adult chestpiece has been precisely machined to exacting tolerance from aluminium
- Double leaf internal spring binaurals are fixed at 15° angle to ensure a comfortable fit in the users ear
- Available in your preferred choice of three tubing colours
- This stethoscope is supplied with an extra set of soft sealing eartips and diaphragm
- Overall length 770 mm



Code	Product Description
NST-BL	Black Tube Stethoscope
NST-NB	Navy Blue Tube Stethoscope
NST-BR	Burgundy Tube Stethoscope

## Non-contact Thermometer

**Gentle, non-invasive & accurate measurement of body temperature**

Simple to use thermometer offers a stable, heat-interference-free reading

- Designed for the periodic measurement and monitoring of body temperature
- Also capable of measuring both ambient and surface temperatures (eg. Baby's milk)
- Accuracy is confirmed by the device's self-test routine when switched on
- Offers a wide range of measurement from 0.1–99.9°C (32.2–211.8°F)
- Recall the last 30 readings with both time and date when entering the recall mode
- Fever alarm gives 10 short beeps and a red LCD backlight alert of high temperature
- Unique probe assembly construction incorporates an advanced infrared sensor, ensures accuracy and reliability of readings



Code	Product Description
AC500	Non-contact Thermometer

## AC200 LED Examination Light

**Bright LED illumination designed in a compact head design.**

Head design offers ease of access to power control combined with a fully-flexible neck which remains in stable once positioned.

LED illumination requires no bulb replacements and consume far less energy.

- Colour temperature: 5,000°K
- IRC: >95
- Luminous intensity: 1m - 11,000 lux
- Average life LEDs: 50,000 hours
- Light angle: 6th
- Field diameter at 1m: 12cm
- Power: 10W
- Thermal protector: Yes



Code	Product Description
AC200FW	Wall Mounted Light
AC200FD	Desk Mounted Light
AC200FM	Mobile Stand Mounted Light

## AC300 LED Examination Light

**Created with a focus on ease of use.**

Designed with ease of use, this range with flex or articulated arm offers complete freedom of movement for accurate light placement, which is quickly adapted when required.

Clinicians can easily adjust the light intensity through the simple touch panel controls. LED illumination requires no bulb replacements and consume far less energy.

- Colour temperature: 5,000°K
- IRC: >96
- Luminous intensity at working distances:
  - at 1m - 35,000 lux
  - at 0.8m - 45,000 lux
  - at 0.5m - 65,000lux
- Average life of LEDs: 50,000 hours
- Light angle: 4th
- Field diameter at 1m: 10cm
- Power: 7W
- Thermal protector: Yes



Code	Product Description
AC300FW	Flexible Arm – Wall Mounted Light
AC300FD	Flexible Arm – Desk Mounted Light
AC300FM	Flexible Arm – Mobile Mounted Light
AC300SW	Spring Arm – Wall Mounted Light
AC300SD	Spring Arm – Desk Mounted Light
AC300SM	Spring Arm – Mobile Mounted Light





## AccoView 500 LED Classic F.O.

Our premium quality professional diagnostic set with enhanced features: fibre optic LED illumination and Classic 2.5v handles.

### 500 LED F.O. Ophthalmoscope

- Sealed, dustproof design protects precision ensuring reliability and longer working-life.
- Bright white 7,000 Lux LED light
- CRI  $\geq 90$  and Red index  $\geq 90$
- Coaxial optics produce shadow-free spot for easier entry into undilated pupils and offers a larger field of view
- 7 Apertures for generalist use as needed

### 500 LED F.O. Otoscope

- Neutral white 75,000 Lux LED light
- CRI  $\geq 95$  and Red index  $\geq 90$
- Distal fibre optic illumination
- Swivel-type window with AR coated 4x lens
- Insufflation port for pneumatic testing of tympanic membrane

## AccoView 500 LED Premier F.O.

Diagnostic sets available with both the 500 Otoscope and 500 Ophthalmoscope heads supplied with premier 3.5v, black Premier handles in a secure storage case.

- Includes both 500 Otoscope and 500 Ophthalmoscope heads
- USB-C type ports to easily charge handles
- Premier 3.5v handle power
- Enhanced brightness control by twisting handle head to dim until the device is powered off.
- Dimming is stepless and gradual
- Ergonomically designed for easy placement of thumb
- Handle automatically turns off after 3 minutes of idle state for enhanced safety of the bulb and battery life



## AccoView 500 Diagnostic Station

A comprehensive wall-mounted solution for hospital and clinic environments. A modern, modular design to serve the needs of practitioners.

This diagnostic station features two Premier AccoView handles with accompanying F.O. LED Otoscope and Ophthalmoscope heads. In addition to this the unit also includes a dispenser for Otoscope single-use ear tips.

Supplied with a wall board for easy mounting of the complete unit. An excellent feature if the unit needs to be removed for maintenance of the facility or moved to a new location.

- Automatic on/off of handle power when removed from cradle
- 3m spiral cord allows comfortable use from different angles for each of the instruments
- Replacement ear tip dispenser offers quick, convenient replacement of Otoscope ear tips.



Code	Product Description
AC500-STA	Diagnostic Station with Tip Dispenser

## AccoView 300 LED Diagnostic Sets

A lightweight, pocket-sized LED illumination diagnostic set. Advanced optics ensures excellent illumination and accuracy of diagnosis in every examination.

### 300 LED Ophthalmoscope

- Bright, long lasting LED illumination
- A selection of 5 varying apertures
- Color coded 18 lenses for excellent resolution

### 300 LED Otoscope

- Distal Fiber Optic LED illumination
- Swivel type window with 3x magnification lens for sharp images and minimal reflection.
- Insufflation port for pneumatic testing of tympanic mobility.



Code	Product Description
AC300-OTS	Otoscope in Soft Pouch
AC300-OTD	Otoscope in Hard Case
AC300-OPS	Ophthalmoscope in Soft Pouch
AC300-OTD	Ophthalmoscope in Hard Pouch
AC300-OTOPE	Set with 1x Handle in Soft Pouch
AC300-OTOPD	Set with 2x Handle in Hard Pouch



Code	Product Description
AC-CS	AccoView Plus Charging Station

## AccoView+ Charging Station

Dual slot charger capable of charging either of the AccoView handles (Classic/Premier).

Desk stand includes two bright OLED displays to easily identify current percentage battery charge status for either handle.

OLED display is also capable of indicating if there are any issues that may interrupt charging, such as reverse polarity.

When the battery is fully charged the charger will automatically cut off power supply to the handle, ensuring both safety and the preservation of handle battery life.

Input power supply 100-250VAC, 50/60Hz



Code	Product Description
SA-90	Portable Screening Audiometer
SA-110	PC-Based Screening Audiometer

## Audiometers

**Small, lightweight and easily portable devices for hearing screening.**

Ideal for Occupational Health nurses or technicians to use, these audiometers provide the testing capability required for workplace industrial screening.

### SA-90 Audiometer

- Simple & easy to use
- Intensity range (-10dB to +90dB)
- Automatic HSE categorisation of results
- USB linked and powered
- Hearing loss prediction capabilities

### SA-110 Audiometer

- Automatic test routines in line with British Society of Audiology
- Wide intensity range (-10dB to +110dB)
- Audiograms can be stored locally on your PC or in a network location
- Recall of stored results to screen for comparison with current test
- Adaption of test protocol to suit patient and operator





Our company accreditations include:

- EC Certification 93/42/EEC
- Registered Quality Assured firm under ISO13485:2016



**MANUFACTURED  
IN THE UK**

V4.0

**ACCOSON™**

+44 (0) 1294 645 685

[sales@accoson.com](mailto:sales@accoson.com)

[www.accoson.com](http://www.accoson.com)

A.C. Cossor & Son (Surgical) Ltd.  
Greig House, Annickbank Campus  
Annick Road, Irvine, Ayrshire  
KA11 4LF, United Kingdom